

PHILIPS

VoiceTracer

多功能语音麦克风

VTR5166

使用手册

User manual



目录

1	欢迎	5	6	现场语音转文本	10
1.1	产品特点	5		6.1PC 端软件	10
2	重要须知	6	7	娱乐休闲	13
2.1	安全	6	7.1	唱歌模式	13
2.2	听力保护	6	7.2	清唱模式	13
			7.3	直播模式	13
3	您的多功能语音麦克风	7	8	回放模式	14
3.1	供货范围	7	9	指示灯说明	15
3.2	概览	7	10	常见故障排除	16
4	开始使用	8	10.1	无法启动	16
4.1	开 / 关机	8	10.2	麦克风无法录音	16
4.2	连接电脑	8	10.3	录音文件无法播放	16
			10.4	麦克风无声音	16
5	录音	9	11	技术参数	17
5.1	录音	9	11.1	存储器	17

11.2 尺寸和重量	17
11.3 系统要求	17
11.4 录音	17
11.5 运行条件	17

1 欢迎

欢迎来到飞利浦世界！您能选择和购买飞利浦的产品，我们非常高兴。您可在我们的官方网站上获得飞利浦公司的全方位技术支持，如：使用手册、软件下载、保修信息等。

www.philips.com

1.1 产品特点

- 一键录音；
- 语音转文本、适合会议、演讲；
- 现场录音、带音效录音、音乐演唱录音；
- 休闲娱乐、唱歌、直播、清唱以及音效多种功能；

2 重要须知

2.1 安全

- 为了避免短路，切勿将产品放置在触水受潮处。
- 不要将产品放在加热设备附近或阳光直射的地方。
- 请注意，切勿挤压电缆，特别是插头处。



小心

- 特别声明：使用本产品前请仔细阅读本说明书，如因人为操作或不可抗力因素而导致数据丢失，本公司一概不予负责。特别提醒用户小心操作，注意将资料另外备份。
- 图像仅作参考。飞利浦保留更改颜色 / 外观 / 设计 / 参数 / 产品功能的权利，恕不另行通知。

2.2 听力保护

使用耳机时请遵守下列原则：

- 调整至合适的音量，切勿长时间使用耳机。
- 特别需要注意，切勿将音量调至耳朵所能承受的范围之外。
- 切勿将音量调至盖过周边环境的声音。
- 在危险情况下请小心或暂停使用耳机。

3 您的多功能语音麦克风

3.1 供货范围:

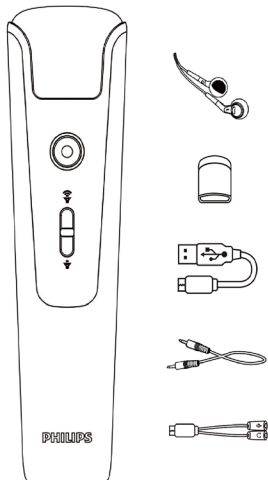

3.2 概览:

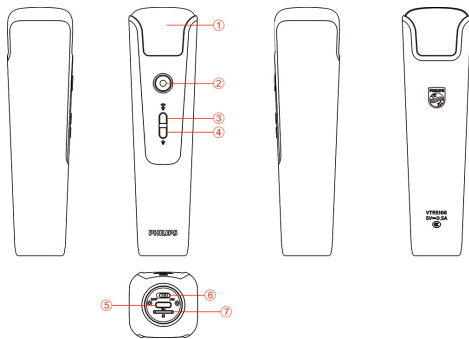

- | | |
|-------------|-------------|
| ① 话筒 | ② 录音键 |
| ③ 音量键+/开音效键 | ④ 音量键-/关音效键 |
| ⑤ TYPE_C口 | ⑥ 开关机键 |
| ⑦ SD卡座 | |

4 开始使用

4.1 开 / 关机

开关按钮推至 ON 为开机，推到 OFF 为关机。

开机后 LED 灯亮，机器进入待机状态，可连接 Type-c 接口唱歌等操作。

4.2 连接电脑

可使用 Type-c 接口的 U S B 线将机器与电脑连接，因机器本身是没有内存的，所以没有插入 T F 内存卡的情况下，连接电脑是没有盘符的，插入 T F 内存卡后，连接电脑才会有盘符显示，盘符的名称随 T F 内存卡的名字而定，一般为可移动磁盘。

5 录音

当您初次使用录音笔录音时，请注意本节中的内容说明！
因机器本身没有内存，录音时需要插入 T F 内存卡才可以使用录音功能。

- (1) 确保 TF 卡插入麦克风。
 - (2) 确保 TF 卡能使用（使用前建议格式化卡）。
 - (3) 确保 TF 卡有足够内存。
 - (4) 确保麦克风电量充足。
-

5.1 录音

在待机状态下，长按“录音”键进入录音，录音红色指示灯亮；
短按“录音”键保存后并退出录音，返回唱歌模式。

6 现场语音转文本

- (1) 笔记本电脑连接：用 Line-in 线 / 伴奏线将设备与笔记本电脑相连，线的一头接 Type-c 的“Line-in”接口，另一头接电脑的耳机口。



- (2) 台式电脑连接：用 line-in 线 / 伴奏线将设备与台式电脑相连，线的一头接 Type-c 线的“耳机”接口，另一头接电脑的 MIC 接口。

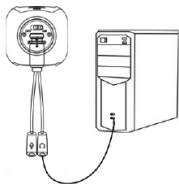

6.1 PC 端软件

- 1 登陆京华数码指定 PC 软件下载路径 (vtr5166.szgps.net) 下载 PC 端软件，在电脑端下载时请记住下载保存路径，下载完成后解压压缩文件即可开始使用。



注意

- 电脑系统是 XP 或 win7 时，请使用文件名为“VTR5166(for-Window-XP-or-7)”的文件包；系统为 win8 或 10 时，请使用文件名为“VTR5166(for-Window-8-or-10)”的文件包。

登录界面：输入正确的产品序列号，输入密码（初始密码：123456），点击登录即可使用此软件，如下图：



- 2 使用 PC 端软件之前，先把设备设置为语音转文本模式。设备开机后，长按音量 - 键 / 关闭音效进去语音转文本模式，

此时 LED 显绿色灯常亮。

- 如与笔记本电脑连接使用，请参考“现场语音转文本”的第一点说明，与台式电脑连接使用，参考第二点说明。
- line-in 线（四节头）如下图：



- 登录后进主界面，主界面包括：录音、语音转文本、实时听写、文件目录、语言设置、消息输送，如下图：

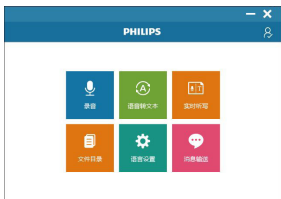

录音界面包括：开始录音、暂停录音、保存录音。

登录后在主界面，可选择“录音”模块进去录音，录音界面如下图所示，选择“完成录音”即可保存当前录音文件，可对录音文件进行语音转文本，也可以去 P C 端文件夹查找“record”文件回放。录音文件本机不支持回放。



语音转文本，选择录音文件转文本，语音转文本界面可以保存文本，编辑文本。



提示

- 安装下载 PC 端软件后，登录软件必须确保网络已连接。
- 电脑端若提示需要安装 framework4.0 的框架时，则需要安装才能使用，以网页域名的方式下载软件。

当网络连接不稳定和信号差时，将会影响翻译的速度以及准确率，建议在网速较好的情况下使用 PC 端软件。

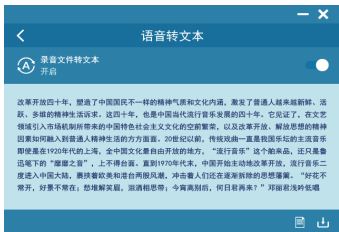

实时听写：选择实时听写菜单，点击进去，即可以边说边翻译，在此界面也可以对翻译后的文本编辑、保存。

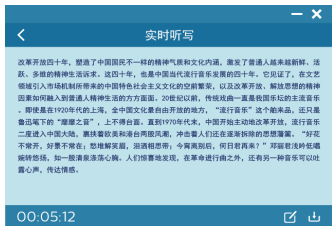

文件目录：选择文件目录菜单，进去后，可以浏览录音文件和文本文件列表。可点击打开文本文件的内容。



选择“消息输送”窗口菜单进去后，点击“▶”图标，弹出提示后按“确定”，鼠标去点击对应输入框即可传送语音转文本消息。



7 娱乐休闲

7.1 唱歌模式

连接好耳机和 line-in 线后，打开手机的唱歌平台如（唱吧、全民 K 歌等平台）可调节混响开 / 关，调节声音大小来达到一个最佳的唱歌模式。连线如下图所示：

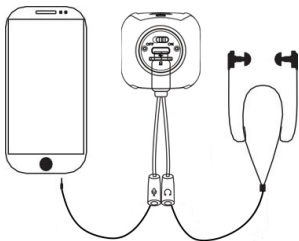

注意

- 使用 K 歌平台 K 歌和录音时，因 iPhone 等部分手机有自带返听功能，与 K 歌麦自带的返听效果叠加，可能会引起啸叫，因此在 K 歌 APP 中需关闭返听功能即人声选项不要调。

7.2 清唱模式

在唱歌模式下，长按音量“-”键 / 关闭音效进入清唱模式。可以通过调节音量大小来调节达到一个最佳清唱状态。清唱接线图如下图所示：

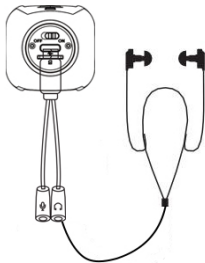

7.3 直播模式

直播接线方式请参考“7.1 唱歌模式”，如需在直播中 K 歌，可以选择：火星直播、虎牙直播、酷狗直播、映客。

8 回放模式

录音回放：用 TYPE_C 接口的 USB 线连接电脑，打开录音文件进行回放（不支持本机回放）。

9 指示灯说明

- (1) 充电时，指示灯为橙色；充满电时，指示灯全灭。
- (2) 低电时，橙色指示灯快闪提示目前为低电状态。
- (3) 录音时：红色灯亮。
- (4) 待机时：绿色灯亮。
- (5) 连接电脑时：橙色灯亮，当使用 PC 端软件录音时，机器指示灯不响应。

10 常见故障排除

此处列举了常见问题的解答，可帮助解决录音笔出现的简单问题。如果故障仍无法排除，请咨询经销商或访问我们的官方网站：www.philips.com/support

10.1 无法启动

电池电量已耗尽，接入 USB 进行充电，确认能否正常启动。

10.2 麦克风无法录音

- (1) 麦克风 TF 卡储存空间已满。
 - (2) 未插入 TF 卡。
 - (3) 卡出错，坏卡。
-

10.3 录音文件无法播放

- (1) 确认录音文件无损坏，正常保存。
- (2) 确认播放器是否支持播放，换不同的播放器播放。支持的播放器有：迅雷影音、千千音乐、QQ 影音、爱奇艺万能播放器、KMplayer。

10.4 麦克风无声音

- (1) 检查是否与手机连接正确；
 - (2) 检查话筒声音是否调小；
 - (3) 麦克风是否已低电关机；
 - (4) 检查手机声音是否调小；
 - (5) 检查与手机连接接口是否接触好，必要时拆出手机保护壳。
-

11 技术参数

11.1 存储器

支持 4G 到 32G 的 MicroTF

11.2 尺寸和重量

宽 × 高: 145×40 (mm)

重量 (含电池): 161g

11.3 系统要求

操作系统: Windows 10/Windows 8/Windows 7/Vista/XP/2000,
Linux

接口: Type-c 接口

拾音器: 14mm 电容式独立悬挂振膜音头

11.4 录音

44.1Khz/4bit: 比特率为 176.4kbps, 格式为 WAV

11.5 运行条件

温度: 5°C - 45°C

空气湿度: 10% - 90%, 不凝结

Content

1 Welcome	19
1.1 Product features	19
<hr/>	
2 Important	20
2.1 Safety	20
2.2 Hearing protection	20
<hr/>	
3 Your Speech to text Mic	21
3.1 What's in the box	21
3.2 Overview	21
<hr/>	
4 Start to Use	22
4.1 Power on/off	22
4.2 Connect to PC	22
<hr/>	
5 Recording	23
5.1 Recording	23
<hr/>	
6 Live Voice to Text	24
6.1 PC software	24

7 Entertainment & Leisure	28
7.1 Singing mode	28
7.2 Solo mode	28
7.3 Live mode	29
<hr/>	
8 Playback Mode	30
<hr/>	
9 Indicator Description	31
<hr/>	
10 Frequently Asked Questions	32
10.1 Fail to start	32
10.2 Fail to record of microphone	32
10.3 The device cannot play recorded audio	32
10.4 No sound of microphone	32
<hr/>	
11 Technical Parameters	33
11.1 Memory	33
11.2 Dimensions & weight	33
11.3 System requirements	33
11.4 Voice recording	33
11.5 Operating conditions	33

I Welcome

Welcome to the world of Philips! We are honored by your choice and purchase of Philips' products. You can have Philips' comprehensive technical supports from our website, e.g. user's manuals, software downloading and warranty information etc.

www.philips.com

1.1 Product features

- One-touch recording on multiple scenes and multiple modes;
- Voice to text, suitable for meetings and speeches;
- Live recording, recording with sound effects, recording of musical singing;
- Entertainment, singing, live, solo and sound effects.

2 Important

2.1 Safety

- To avoid short circuits, never place the product in a location where it is exposed to moisture.
- Do not place the product near heated equipment or in direct sunlight.
- Please be careful not to pinch the cable, especially at the plug.



Warning

- **Special Announcement:** Before using the product, please read the Manual carefully. Our Company shall not be held liable for any data loss due to incorrect manual operation or force majeure. We specially recommend that users make additional copies of the files in the device.
- Images are for reference only. Philips reserves the right to change the color/appearance/design/parameters/product functions without prior notice.

2.2 Hearing protection

Please observe the following guidelines when using headphones:

- Adjust to the appropriate volume and do not use the headphones for a long time.
- It is especially important to note that the volume should not be adjusted beyond the range that the ear can withstand.
- Do not adjust the volume to level that covers the sound from surrounding environment.
- Be careful or suspend the use of headphones in hazardous situations.

3 Your Speech to text Mic

3.1 What's in the box:

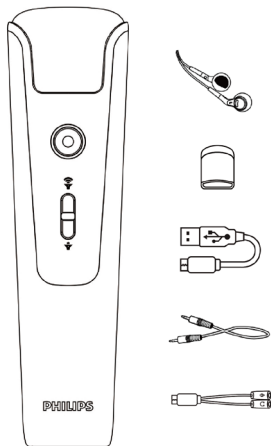

3.2 Overview:

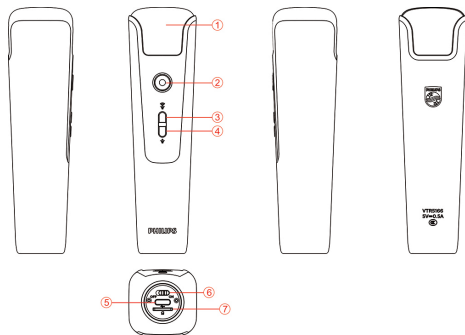

- ① Microphone
- ② Recording button
- ③ Volume button + / on
- ④ Volume button - / off
- ⑤ TYPE_C port
- ⑥ Power button
- ⑦ SD card holder

4 Start to Use

4.1 Power on/off

When the power button is pushed to ON, it is turned on, and when it is pushed to OFF, it is turned off.

After it is turned on, the LED light gets on and the machine enters the standby state. Then it can be connected to the Type-c interface for singing and other operations.

4.2 Connect to PC

The USB cable of type-C interface can be used to connect the device to the computer. Since the device itself has no memory, there is no drive letter when the TF memory card is not inserted. After the TF memory card is inserted, the drive letter will be displayed on the connected computer. The name of the drive letter depends on the name of the TF memory card, which is generally a removable disk.

5 Recording

When you first use the recorder, please pay attention to the instructions in this section!

Since the machine itself has no memory, the recording function can only be used by inserting TF memory card.

- (1) Make sure the TF card is inserted into the microphone.
 - (2) Make sure the TF card functions normally (Formatting is recommended before use).
 - (3) Make sure the TF card has enough memory.
 - (4) Make sure the microphone is fully charged.
-

5.1 Recording

In the standby mode, long press the “Record” button to begin the recording, and the red indicator light is on; Short press the “Record” button to save and exit the recording, and return to the singing mode.

6 Live Voice to Text

- (1) Laptop connection: Connect the device to the laptop with a Line-in cable/accompaniment line. One end of the cable is connected to the Line-in port of USB dongle, and the other end is connected to the headphone port of the laptop.



- (2) Desktop computer connection: Connect the device to the desktop computer with a line-in cable/accompaniment line. One end of the cable is connected to the headphone port of USB dongle, and the other end is connected to the MIC port of the computer.



6.1 PC software

- 1 Log into the link (vtr5166.szgps.net) which provided by JWD to download the PC software and copy the whole folder to a location on the PC.

Note

- When the computer system is XP or Windows 7, please use the folder named“VTR5166(for-Window-XP-or-7)”.
- When the computer system is Windows 8 or 10, please use the folder named“VTR5166(for-Window-8-or-10)”.

Login interface: Enter the correct product serial number, enter the password (initial password: 123456), click Login to use this software as shown below:

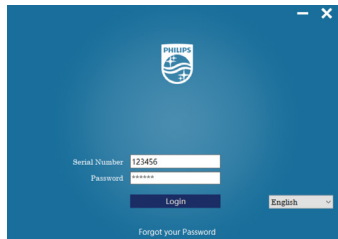

- 2 Set the device to voice-to-text mode before using the PC software. After the device is turned on, long press and the volume- button / turn off the sound effect to enter the voice-to-text mode. At this time, the LED keeps green.
- 3 If it is connected to a laptop, please refer to the first point of “Live Voice to Text” for connection to a desktop computer. If it is connected to a desktop, please refer to the second point for instructions.
- 4 line-in cable (four-section head) is as shown below:



line-in

- 5 After logging in, go to the main interface. The main interface includes: Record, Voice-to-text, Real-time transcription, File directory, Language setting, Send message.

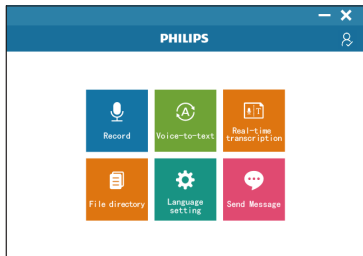

The recording interface includes: start recording, pause recording, and save recording.

After logging in, in the main interface, you can select the “Start recording” module to enter the recording. The recording interface is as shown below. Select “Done” to save the current recording file. You can make the recordings directly on the micro TF card and move them to the PC for transcription. But you cannot playback the recordings directly from the micro TF card.

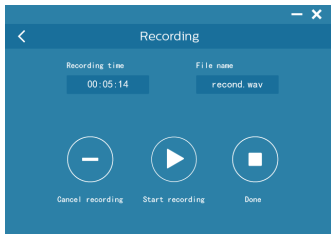

In the case of voice-to-text, select recording file to be transcribed into text, and save and edit text on the voice-to-text interface.



Reminder

- After installing the downloaded PC software, ensure that the network is available in the login of the software.
- If the computer prompts you to install Framework4.0, you need to install it before you use it. You can download the software with a web domain name.

When the network connection is unstable and the signal is poor, it will affect the speed and accuracy of translation. It is recommended to use the PC software when the network speed is favorable.

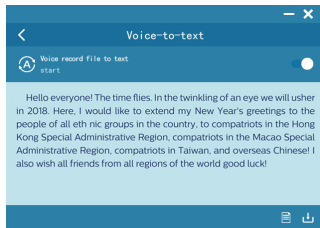

Real-time dictation: Select the real-time dictation menu. Click to enter, you can translate while speaking, and edit and save the translated text on this interface.

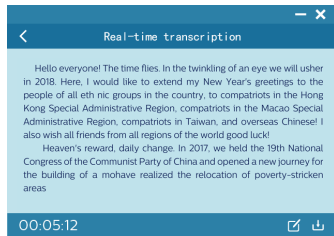

File directory: Select the file directory menu. After entering, you can browse the list of recorded files and text files. Click to open the text file through it.

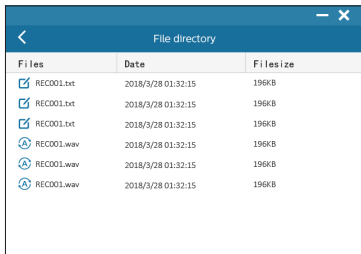

The screenshot shows a window titled "File directory" with a table of files. The table has three columns: "Files", "Date", and "File size". There are six rows of files, each with a checkbox icon to its left. The first three rows are for "RECO01.txt" files, and the last three are for "RECO01.wav" files. All files have a date of "2018/3/28 01:32:15" and a file size of "196KB".

Files	Date	File size
<input checked="" type="checkbox"/> RECO01.txt	2018/3/28 01:32:15	196KB
<input checked="" type="checkbox"/> RECO01.txt	2018/3/28 01:32:15	196KB
<input checked="" type="checkbox"/> RECO01.txt	2018/3/28 01:32:15	196KB
<input checked="" type="checkbox"/> RECO01.wav	2018/3/28 01:32:15	196KB
<input checked="" type="checkbox"/> RECO01.wav	2018/3/28 01:32:15	196KB
<input checked="" type="checkbox"/> RECO01.wav	2018/3/28 01:32:15	196KB

After selecting the “message delivery” menu, click the “▶” icon, press “OK” after the prompt pops up, and click the corresponding input box to transfer the voice-to-text message.

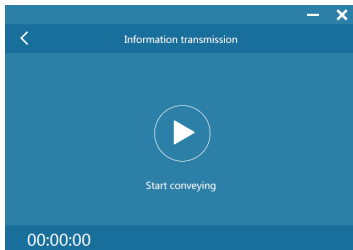

7 Entertainment & Leisure

7.1 Singing mode

After connecting the headphones and the line-in cable, open the singing platform of the mobile phone, such as Changba, National Karaoke and other platforms to adjust the reverb on/off, adjust the sound volume to achieve an optimal singing mode. The connection is as shown below:

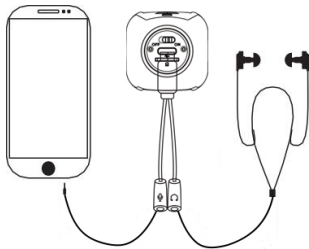

Note

- Do not mistake the accompaniment line with the headphone cable.

Note

- When using voice recording with Karaoke APPs, some mobile phones such as iPhone have built-in playback function and superimposed with the playback effect of Karaoke may cause howling. Therefore, it's necessary to turn off the playback function(vocal option) in the Karaoke APPs.

7.2 Solo mode

In the singing mode, long press volume “-” button / turn off the sound to enter the solo mode. You can adjust to the best solo state by adjusting the volume. The connection for solo is as shown below:

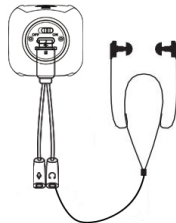

7.3 Live mode

For live broadcast connection, please refer to “7.1 Singing Mode”. If you want to sing a song on live broadcast mode, you can choose: Mars Live, Huya Live, Kugou Live, and Inke Live.

8 Playback Mode

Playback of recording: Connect the computer with the USB cable of the TYPE_C port, and open the recording file for playback (not available to native playback).

9 Indicator Description

- (1) When charging, the indicator light is orange; when fully charged, the indicator light is completely off.
- (2) When the battery is low, the orange indicator light flashes to indicate that it is currently in a low power state.
- (3) When recording: The red light is on.
- (4) When standby: the green light is on.
- (5) When connecting to a computer: The orange light is on. When recording with the PC software, the device indicator does not respond.

10 Frequently Asked Questions

Answers to the frequently asked questions are listed here to solve simple issues during use of the device. If such issues persist, please consult our dealers or visit our official website: www.philips.com/support

10.1 Fail to start

The battery is exhausted. Please connect it with USB for charging to ensure that it can start normally.

10.2 Fail to record of microphone

- (1) Microphone TF card storage space is full.
 - (2) The TF card is not inserted in.
 - (3) Card error: a bad card.
-

10.3 The device cannot play recorded audio

- (1) Confirm that the recorded files are not damaged and are saved normally.
- (2) Confirm whether the player supports playback and play it

with different players. Support the following players: Xunlei Video, Qianqian Music, QQ Video, iQiyi Universal Player, KMplayer.

10.4 No sound of microphone

- (1) Check if the connection with the mobile phone is correct.
- (2) Check if the microphone has been adjusted to mute state.
- (3) Whether the microphone has been powered off because of low power state.
- (4) Check if the mobile phone has been adjusted to mute state.
- (5) Check if the connection with the mobile phone is in good contact, and remove the protection shell of the mobile phone if necessary.

11 Technical Parameters

11.1 Memory

Support MicroTF of 4G to 32G

11.2 Dimensions & weight

Width × height: 145 × 40 (mm)

Weight (with battery): 161g

11.3 System requirements

Operation system: Windows 10/Windows 8/Windows 7/
Vista/XP/2000, Linux

Interface: Type-c port

Sound pickup: 14mm capacitive independent suspension
diaphragm head

11.4 Voice recording

44.1Khz/4bit: bit rate 176.4kbps in WAV format

11.5 Operating conditions

Temperature: 5°C–45°C

Air humidity: 10% – 90%, no condensation

Warranty card

质保书

1 year warranty

一年质保

Type: VTR5166

Serial nr: _____

Date of purchase

购买日期

Dealer's name, address and signature

销售商名称、地址及签字

www.philips.com/welcome

This document is printed on chlorine free produced paper

Data subject to change without notice

This product was brought to the market by Speech Processing Solutions GmbH or one of its affiliates, further referred to in this document as SPS, which is the manufacturer of the product. SPS is the warrantor in relation to the product with which this booklet was packaged.

For China only
只限中国地区

Printed in China



